

PROJECTION SCREEN ASSEMBLY MANUAL

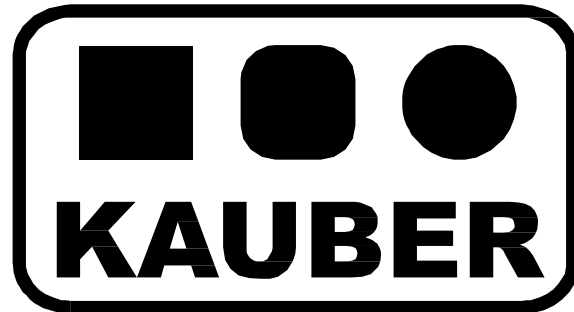

RED LABEL



Red Label is the newest series of projection screens from KAUBER, designed for avid cinematography fans. This model is characterised by increased distance between the projection surface and the wall and thus can be installed directly over flat TV screen.

NOTE!!!

ASSEMBLY AND MAINTENANCE NOTES

1. Downside screen bar has damage-protection tape. Remove the tape only after step 6 of the following manual.
2. Assemble the screen away from moisture and strong sunlight.
3. Clean with soft, moist cloth. Do not use abrasive cleaning agents. Protect inside of the screen from water and other liquids. After cleaning, remove all moisture carefully with a dry cloth.

Contents of the set:	Quantity
Projection screen	1 pc.
Assembly handle	2 pcs.
Ceiling assembly angle bar	2 pcs.
Screw Ø 6x60	6 pcs.
Rawlplug Ø10	6 pcs.
Bolt M6x12	4 pcs.
Pad M6	10 pcs.
Key for screen end positions adjustments	1 pc.
Wall key switch (available with screen without built-in radio control)	1 pc.

SCREEN ASSEMBLY

1. Screw assembly handles to the wall 20cm from ends of the case (Fig.1). Case dimensions are described at the end of the manual under „Technical data”.



Fig.1

2. Depending on the assembly place, screw the handles to the wall (Fig.2a) or the ceiling (Fig.2b) using assembly screws.
NOTE! Screws included in the set may be used only for ceilings made of full materials (e.g. concrete, Suporex). In the case of screwing the screen to other materials, choose appropriate screws.

Wall assembly

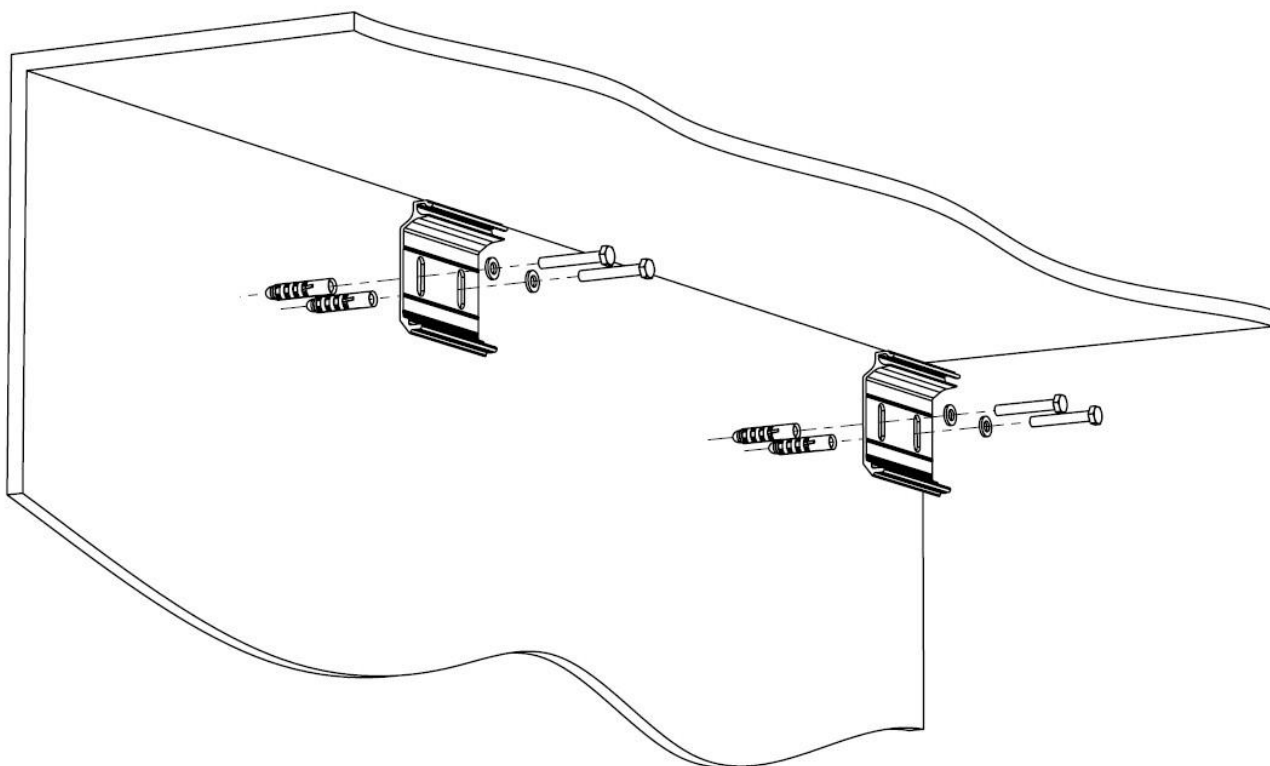

Fig.2a

Ceiling assembly

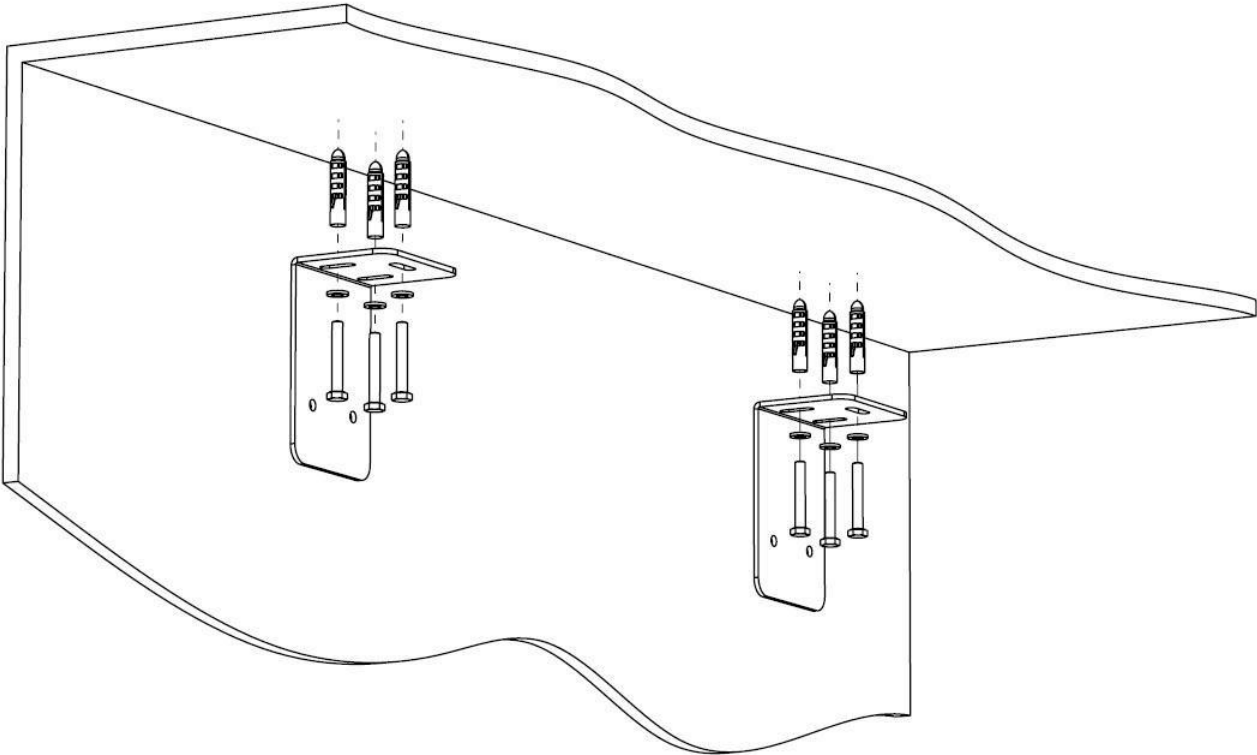

Fig.2b

3. In the case of ceiling assembly, connect handles to angle bars using bolts from the set.

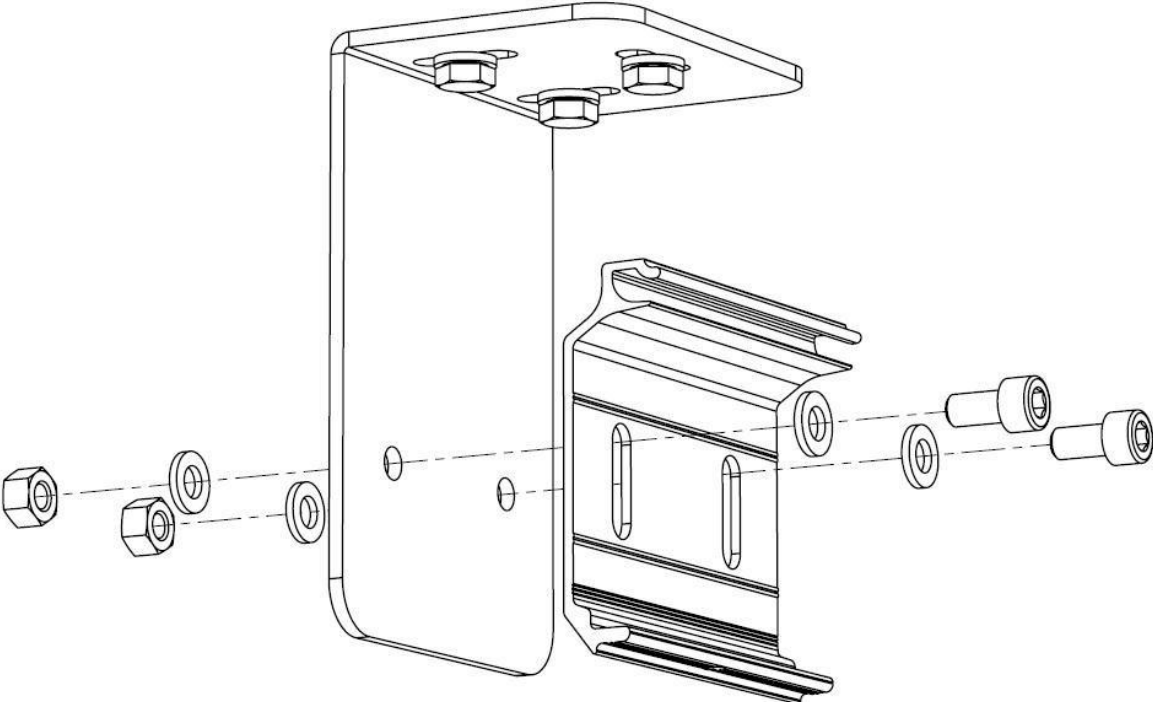

Fig.3

4. Put the screen on the installed handles as shown in the pictures below.

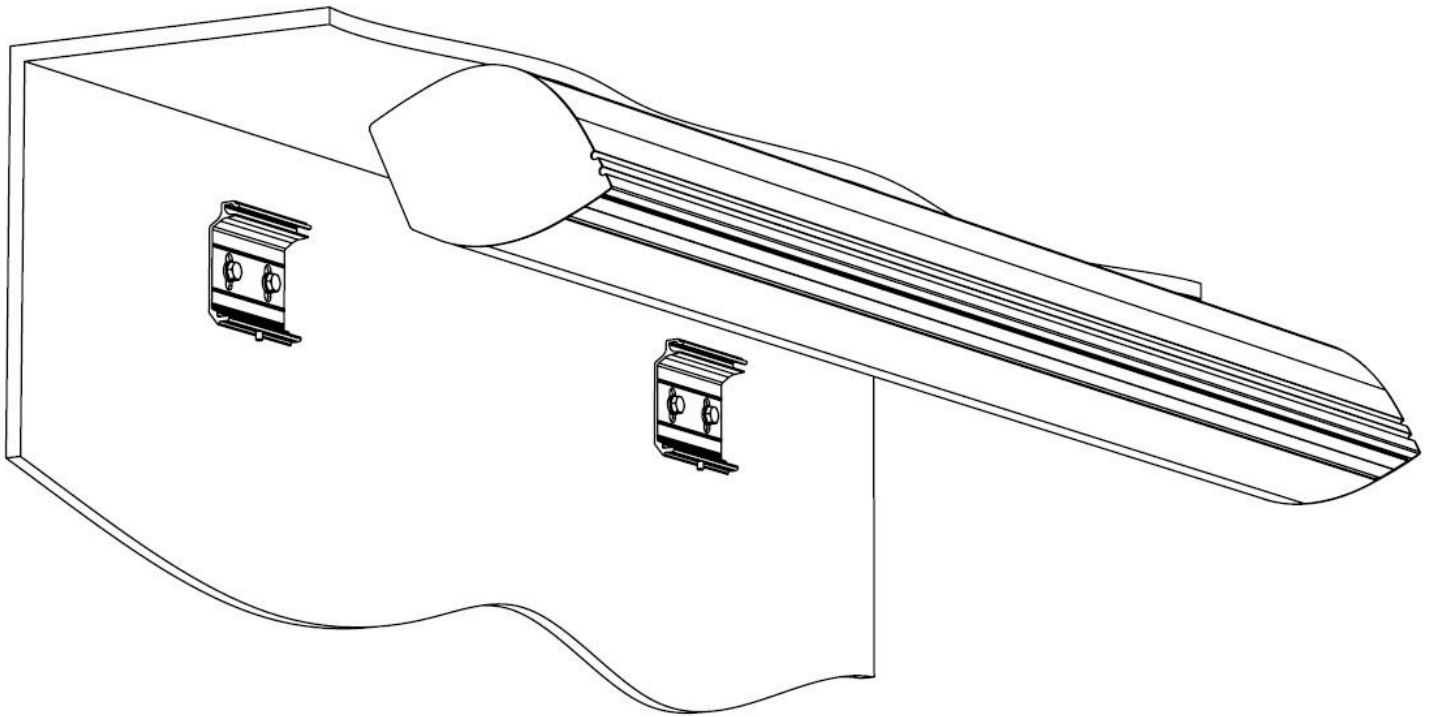

Fig.4

5. The grapple system is shown in the pictures below.
Grappling the screen may be described in 3 steps:

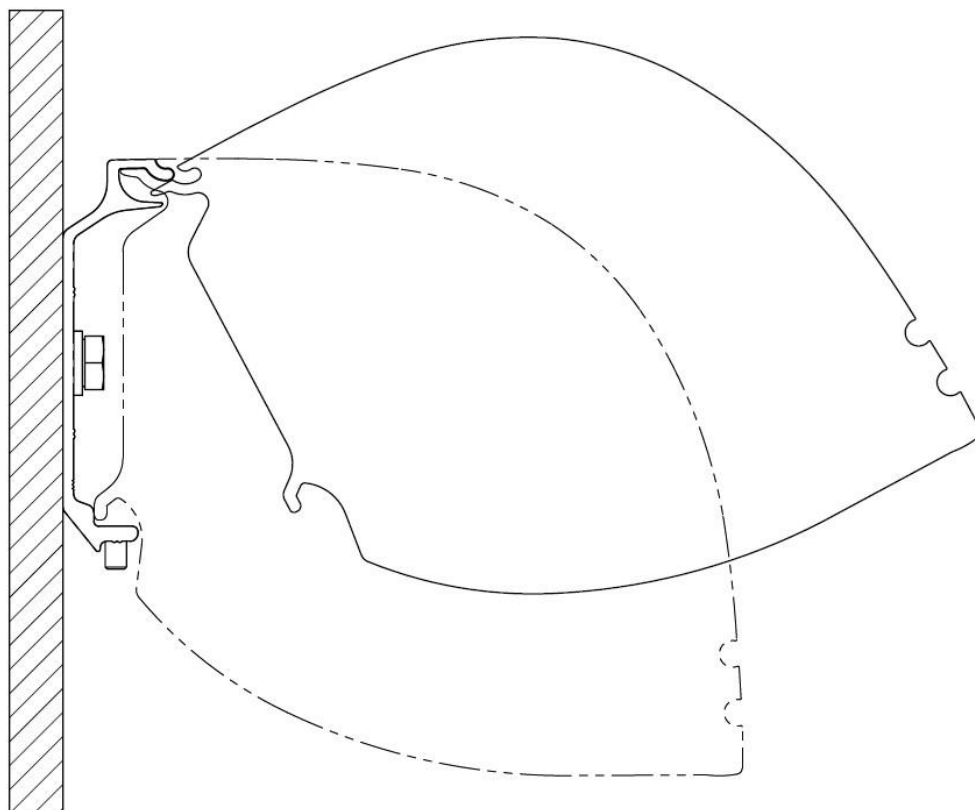

Fig.5

- Block the installed screen using blocking bolts in the handles.

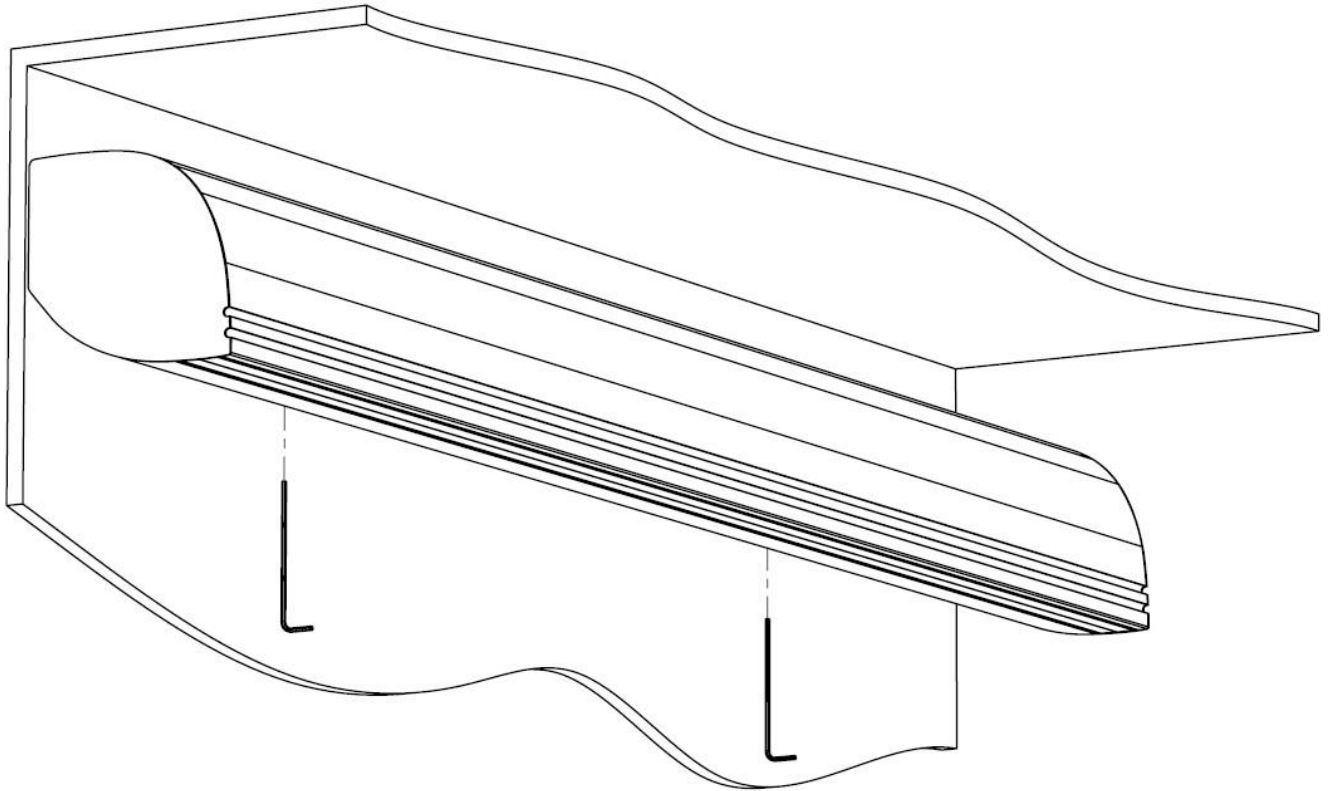

Fig.9

- Delivered screen has end positions requested by the client. If the surface of the screen hangs too high or too low, its position may be adjusted using key from the set (fig.10).

NOTE! End positions corrections may be done only by a qualified person. All corrections done are one's own responsibility. In the case of incompetent corrections, the screen may sustain damage, which is not covered by the warranty.

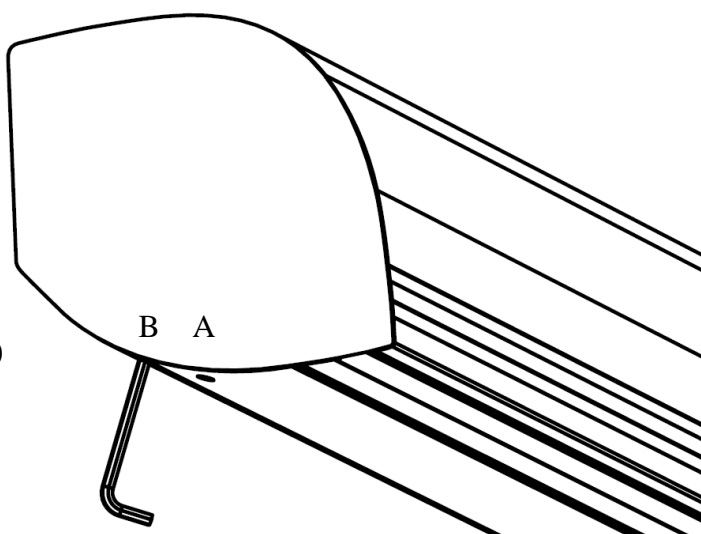

Fig.10

Limiting switch access

Limiting switch A: responsible for upside position of the screen bar. Clockwise regulation will stop the screen bar higher. Anti-clockwise regulation will stop the screen bar lower.

Limiting switch B: responsible for downside position of the screen bar. Clockwise regulation will stop the screen bar higher. Anti-clockwise regulation will stop the screen bar lower.

- In screens with side tensioning, unroll the surface completely. If necessary, adjust tension power with bolts placed on both sides of the bottom bar using allen key.

ELECTRICAL CONNECTION

The screen should be connected to the power supply only by a person with proper electrical qualifications.

Before assembling the screen case, lead the power cord to the assembly place, then connect it to the screen during the assembly as shown on diagram A (Fig.11A) or, in the case of the screen with built-in radio control, as shown on diagram B (Fig.11B).

DIAGRAM A

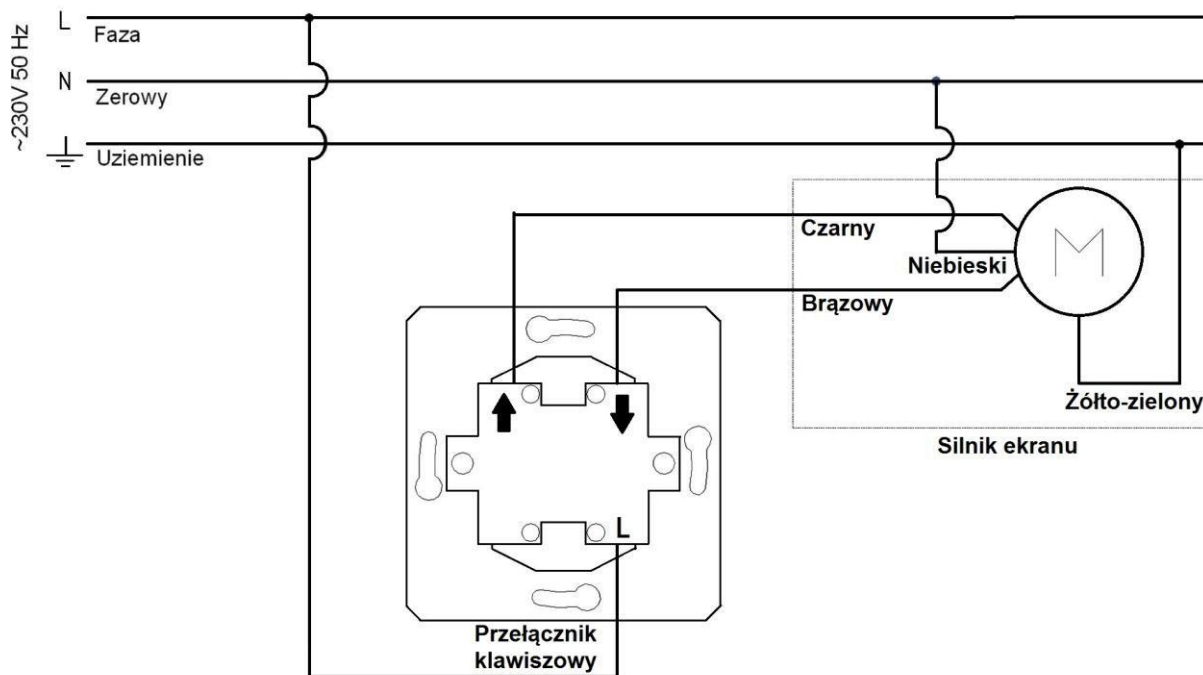

Fig. 11A

DIAGRAM B (built-in radio control)

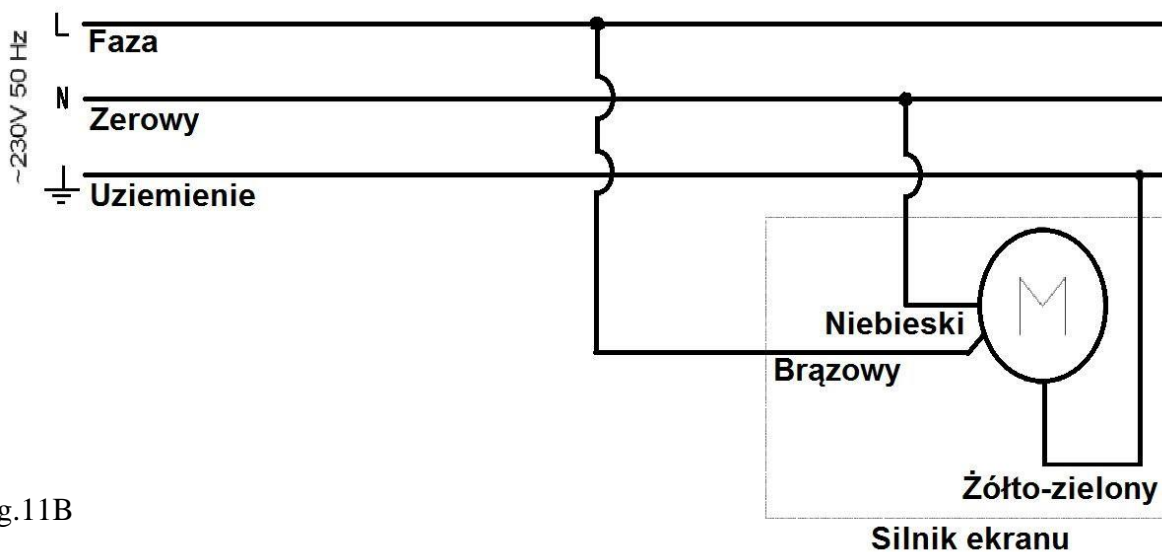

Fig.11B

Connecting key switch from the set.

(Key switch is available in the set with screen without built-in radio control)

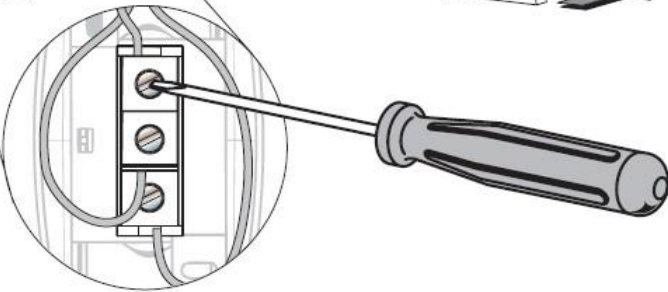
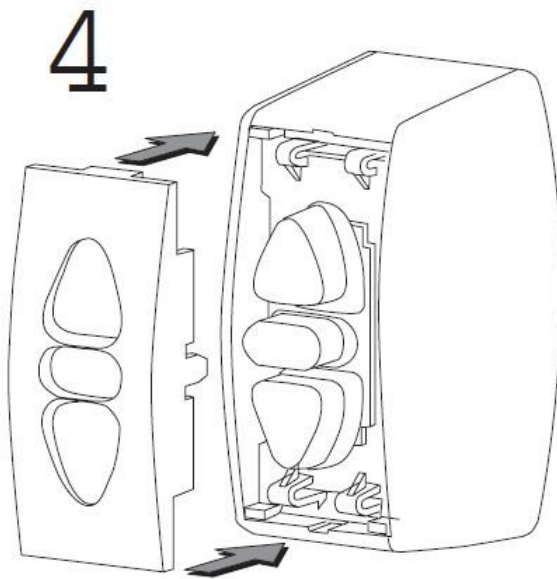
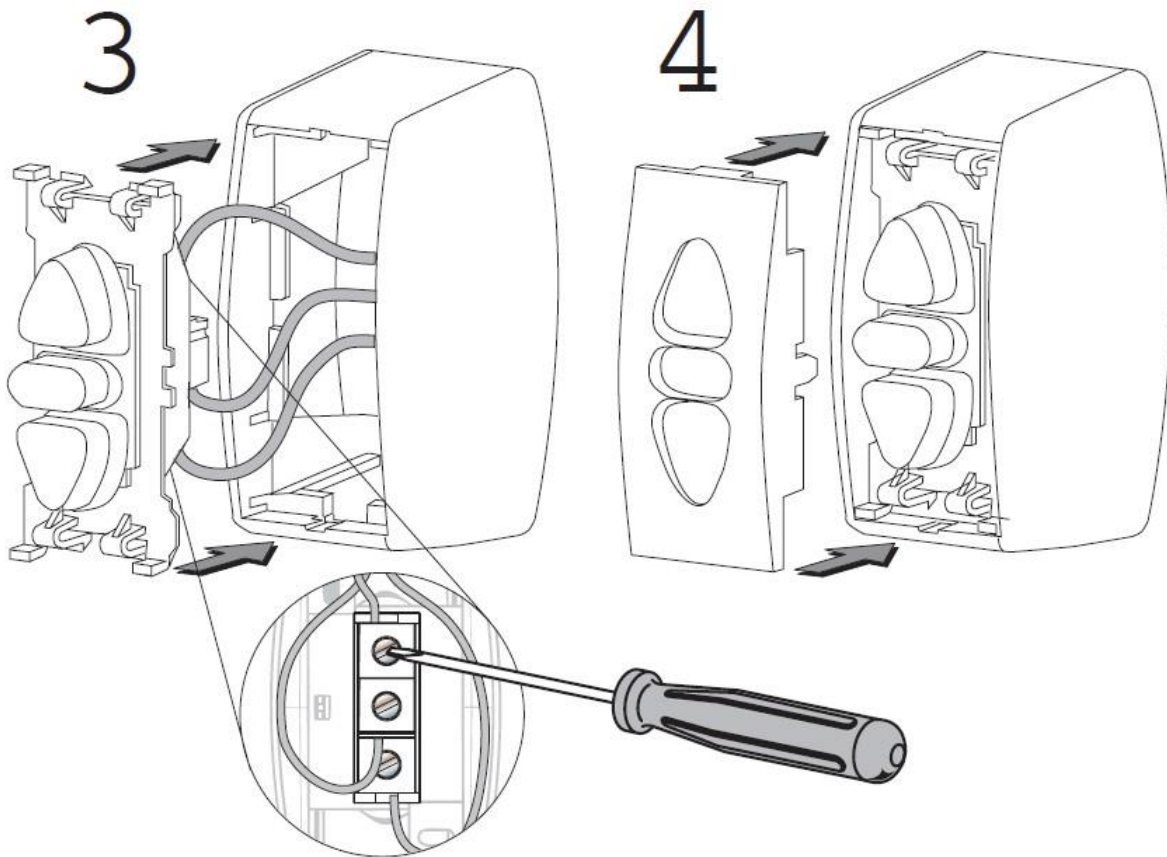
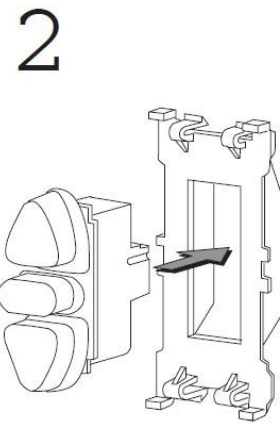
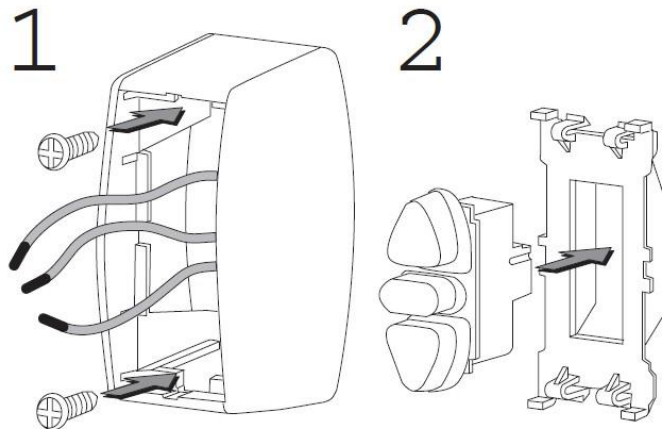
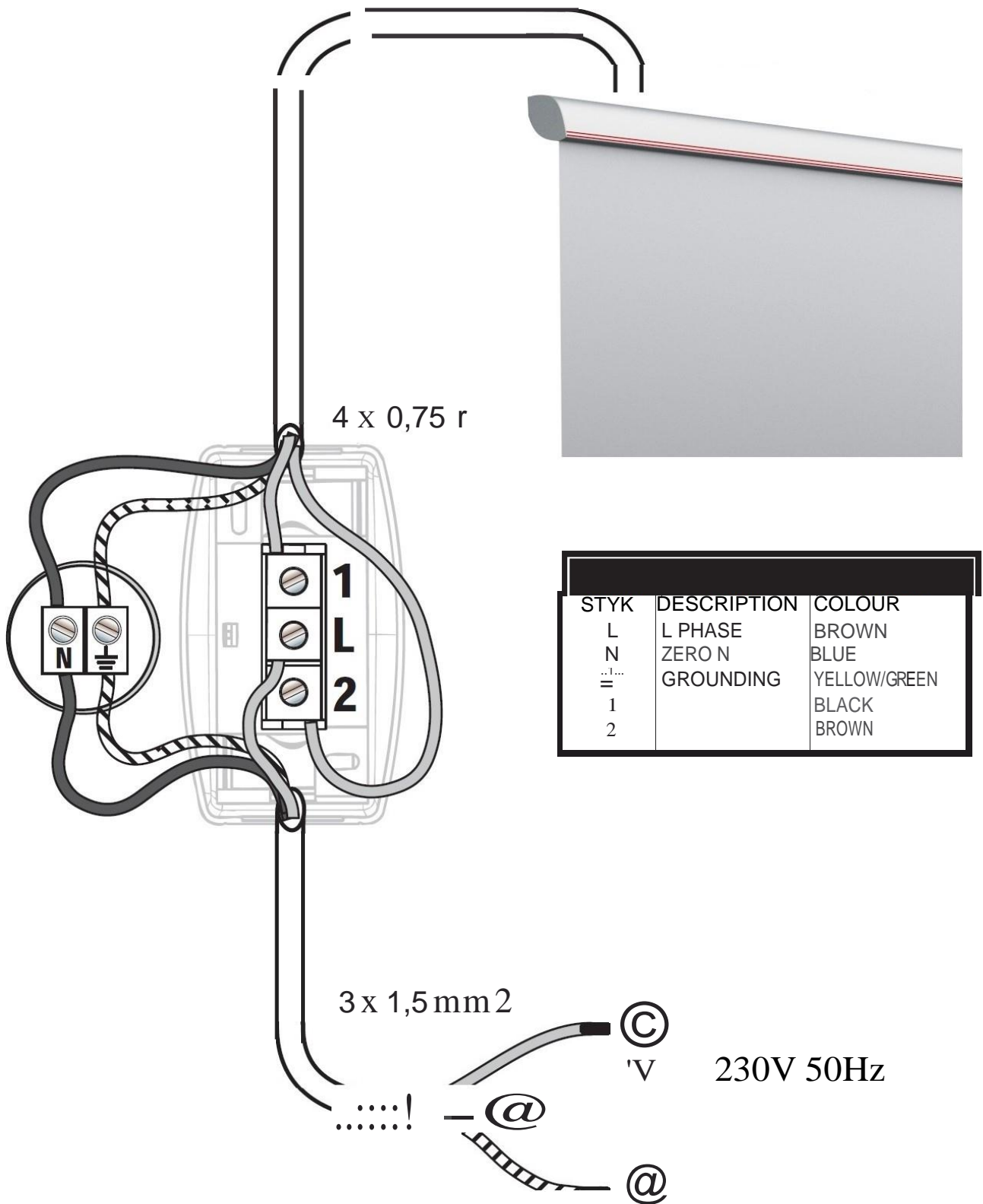
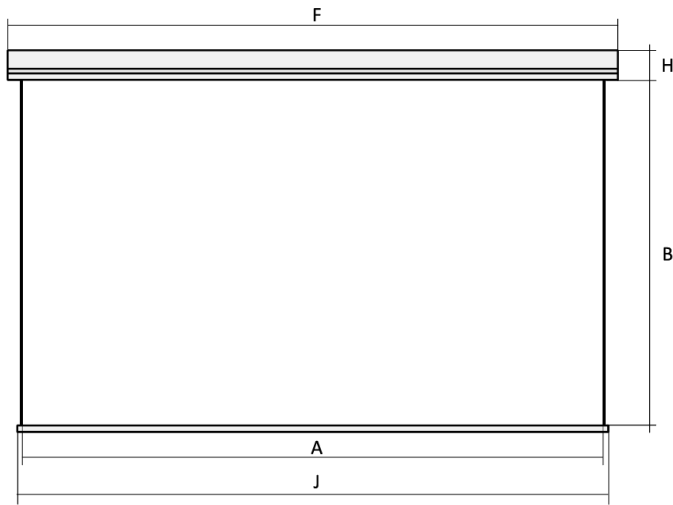
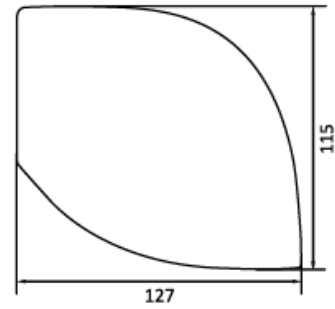

Diagram of connecting key switch to the screen



TECHNICAL DATA

Case dimensions (with covers):



RED LABEL

A- surface width
 B- surface height
 $F=A+64\text{mm}$
 $J=A+30\text{mm}$
 $H=115\text{mm}$

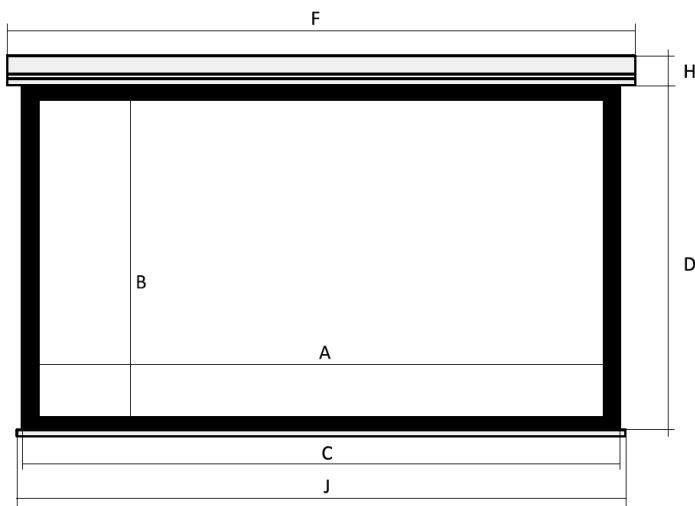

RED LABEL + BLACK FRAME

A- active surface width
 B- active surface height
 $C=A+100\text{mm}$
 $D=B+100\text{mm}$
 $F=A+164\text{mm}$
 $J=A+130\text{mm}$
 $H=115\text{mm}$

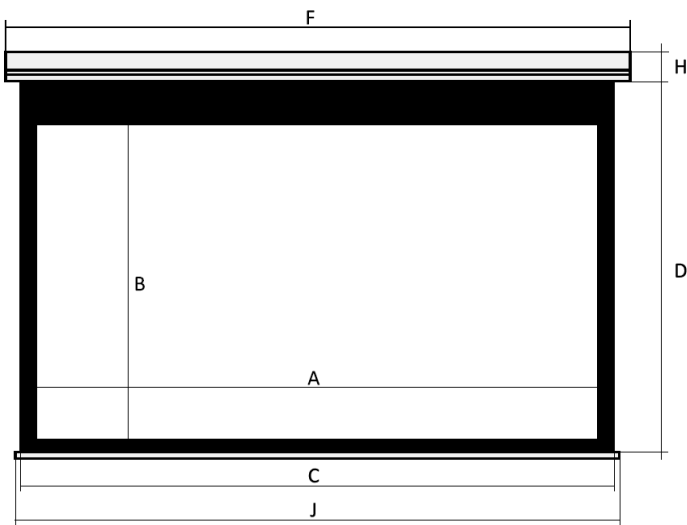

RED LABEL + BLACK FRAME+ BLACK BELT

A- active surface width
 B- active surface height
 $C=A+100\text{mm}$
 $D=B+50\text{mm}+\text{black belt height}$
 $F=A+164\text{mm}$
 $J=A+130\text{mm}$
 $H=115\text{mm}$

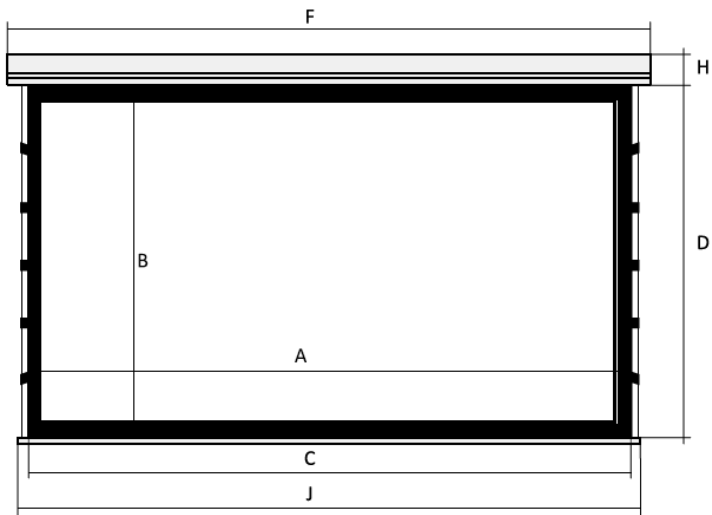

RED LABEL + TENSIONERS

A- active surface width
 B- active surface height

$C=A+100\text{mm}$

$D=B+100\text{mm}$

$F=A+316\text{mm}$

$J=A+270\text{mm}$

$H=115\text{mm}$

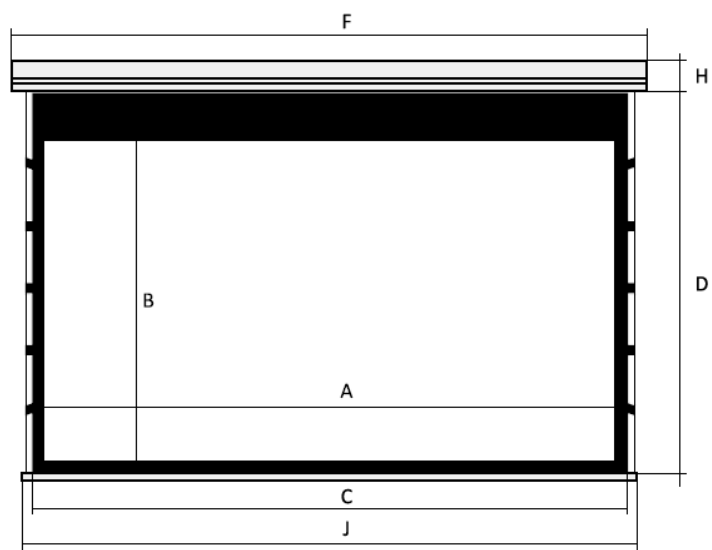

RED LABEL + TENSIONERS + BLACK BELT

A- active surface width
 B- active surface height

$C=A+100\text{mm}$

$D=B+50\text{mm}+\text{black belt height}$

$F=A+316\text{mm}$

$J=A+270\text{mm}$

$H=115\text{mm}$

Technical data:

Powering: 230V 50Hz

Power: 140W – screen without built-in radio control

160W – screen with built-in radio control

Thank you for choosing KAUBER
Buy other KAUBER products on our website

w w w . k a u b e r . e u